

**STEP 1**

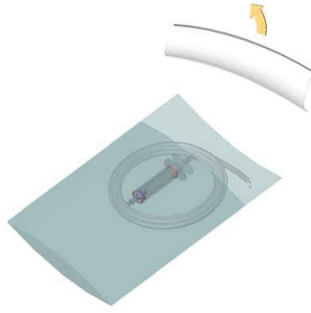

**STEP 2**



**STEP 3**



**STEP 4**

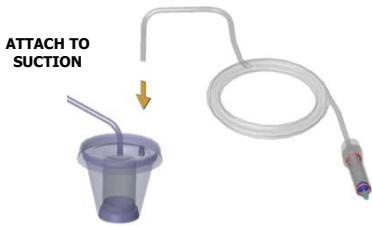

**STEP 5**

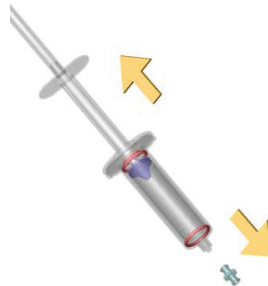

**STEP 6**

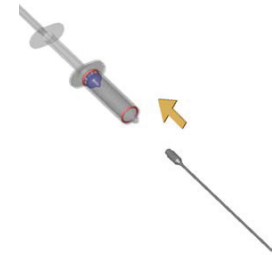

**STEP 7**



**SUCTION  
ON**

**STEP 8**

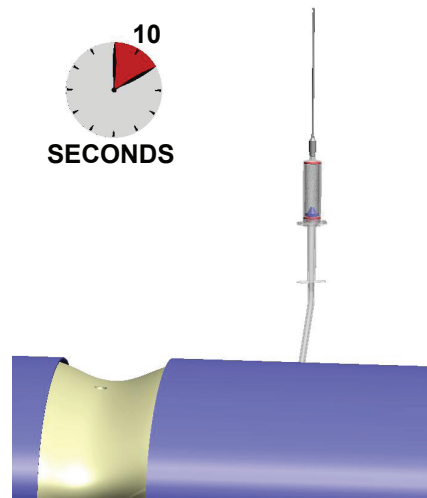
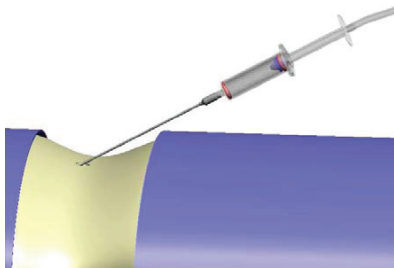

**STEP 9**

**SUCTION  
OFF**

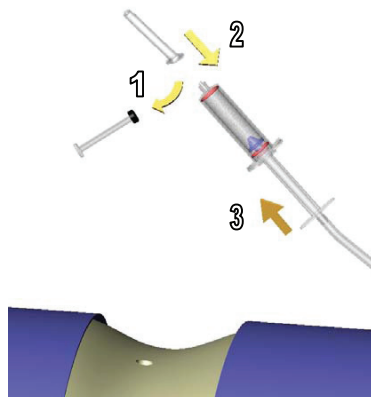
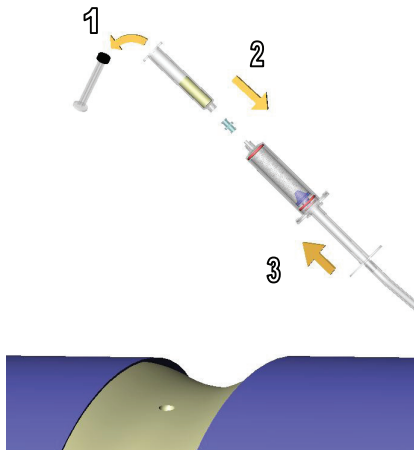

**OPTION 1:**  
USE TRANSFER ADAPTER FOR  
LUER-TO-LUER TRANSFER

**OPTION 2:**  
TRANSFER DIRECTLY INTO BACK OF  
SYRINGE