

EXACTECH | SHOULDER



equinox[®]
PLATFORM SHOULDER SYSTEM

Platform Shoulder System

Assemble what the situation requires.



Platform Shoulder System

No matter what challenges a surgeon may face, the Equinox[®] Shoulder System offers true reversatility. This platform shoulder system enables surgeons to convert from either a primary or fracture stem to a reverse shoulder without stem removal. Additionally, the use of the same humeral instrumentation and humeral preparation for various indications standardizes the procedure and empowers the surgeon to intra-operatively decide 'primary vs. reverse' or 'hemi vs. reverse.'

Be prepared to handle all of these challenges seamlessly—experience the power of the Equinox Shoulder System.



7x Reduction in Scapular Notching¹ ...and no sacrifice of glenoid fixation or stability.²



**Reported Scapular Notching Rate for
Grammont-Style Reverse Shoulder Prosthesis**

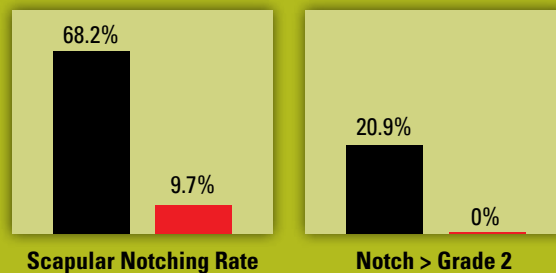

■ Grammont-Style Prosthesis, weighted average of 8 studies, n=868¹
■ Equinox Reverse, 7 site multicenter study, n=226¹

Reverse Shoulder

The Equinox Reverse is designed to minimize scapular notching and enhance glenoid fixation. Its components build off the Equinox primary and fracture humeral stems, which provides intra-operative flexibility and enables surgeons to convert a well-fixed stem to a reverse without stem removal.

The system offers a wide range of glenoid solutions, designed for challenging bony defects.

Minimize Scapular Notching

The Equinox Reverse lateralizes the humerus, which better tensions the muscles¹⁴ and addresses the scapular notching challenge, by using larger glenospheres and decreasing the humeral neck angle. The innovative glenoid baseplate design has a built-in offset which distally shifts the glenosphere to a position that prevents humeral liner impingement on the inferior glenoid.^{4,5}

Enhance Glenoid Fixation

The press-fit bone cage of the glenoid baseplate provides strong initial fixation^{15,16}, while the baseplate provides up to 30 degrees of angular variability to ensure optimal compression screw placement and purchase, even in poor quality bone.⁶ Bone graft can be inserted into the cage to promote bone through-growth⁷, which enhances the probability of long-term biologic fixation. The larger diameter glenospheres result in a medialized center of rotation, thereby minimizing the torque on the glenoid.

Revision Friendly

The six screw holes on the baseplate are positioned to provide optimal screw fixation, even when revising a pegged or keeled glenoid to a reverse shoulder. The offset bone cage of the glenoid baseplate is sized and positioned to be placed in the center of the glenoid to fill a central bone defect while distally shifting the glenosphere to ensure inferior overhang.

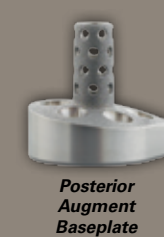
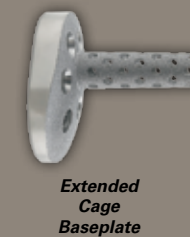
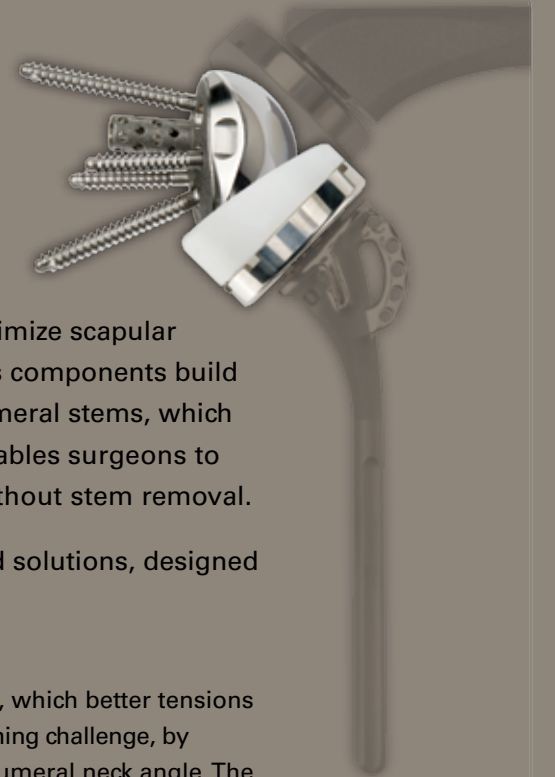

Either track. Same platform.

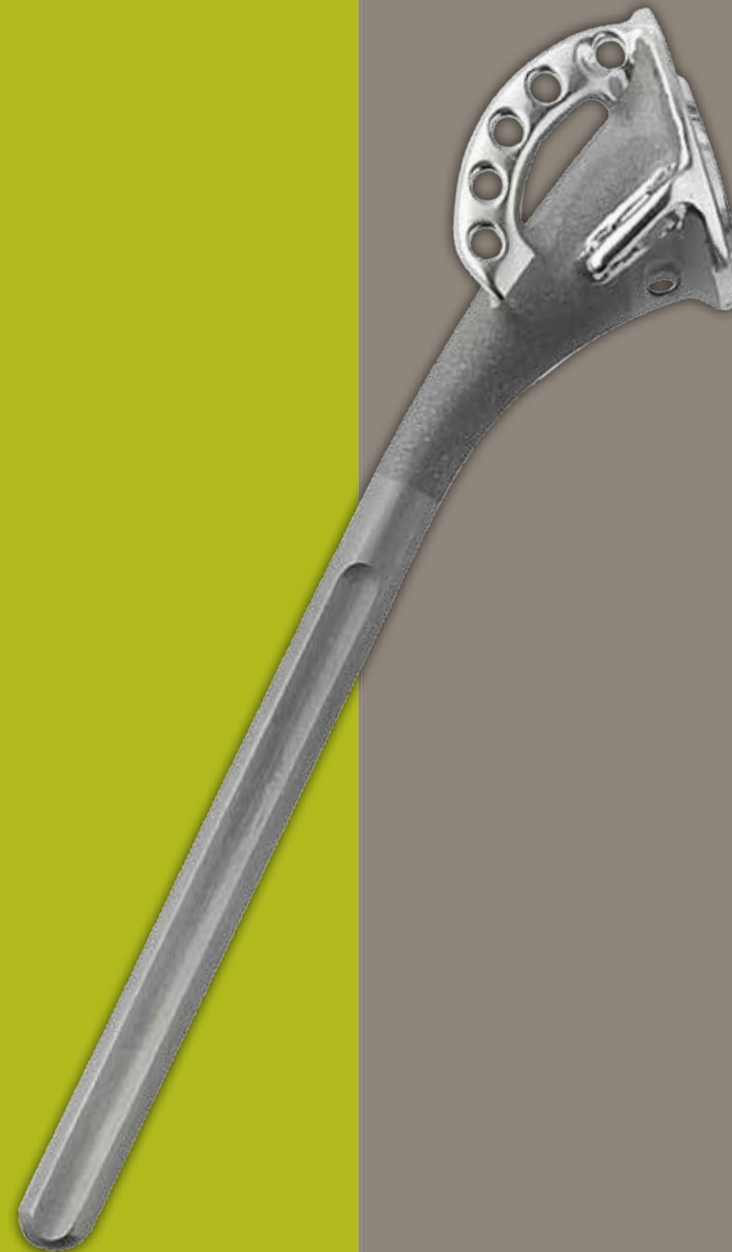

Platform Fracture Stem

The Equinox Platform Fracture Stem empowers surgeons to address complex fractures intra-operatively with a hemi or reverse shoulder arthroplasty. The stem reconstructs the patient's anatomy with a patented anterior-lateral fin and asymmetric tuberosity beds that act as a scaffold to accurately position the greater and lesser tuberosity.

Standardized Reproducible Suture Technique

The Equinox suture technique is designed to establish tuberosity fixation and minimize micromotion. The points of contact for the sutures are polished and have rounded edges, allowing surgeons to compress bone fragments for a stable reconstruction.

Patented Anterior-Lateral Offset Fin

The offset anterior-lateral fin, when placed in the bicipital groove, assists the surgeon in correctly establishing retroversion.⁸⁻¹⁰ The fin features multiple holes with rounded edges providing suture versatility.



Strong support where you need it.



Fx Plate

The Equinox Fx Plate is redefining anatomic fracture reconstruction. The locking plate provides multiple configurations of blades and screws to address a myriad of classifications of proximal humerus fractures. The contoured design allows suture placement and void filler deployment after the plate is secured.

Anatomic. Redefined.

The contoured plate is asymmetric to align with the bicipital groove and greater tuberosity, and tapered distally to respect the deltoid insertion. The suture holes are anatomically oriented, allowing surgeons to pass the suture after the plate is secured to the bone.

Minimize Humeral Head Collapse

Unique modular blades can be inserted to further buttress the reconstruction while locking screws diverge to support the humeral head. The large central hole allows for either a 6.5mm locking screw or deployment of bone-void filler after the plate is secured.

Flexibility

Multiple screw/blade configurations enable a surgeon to treat a spectrum of proximal humeral fractures. Robust instrumentation options are included to address a wide array of surgical technique preferences.

In situ adjustability. Infinite possibilities.



Primary Shoulder

The Equinox Shoulder System redefines “anatomical.” The primary shoulder allows the surgeon to replicate a patient’s unique anatomy by independently adjusting the four anatomic parameters *in situ*.

Patented Replicator Plate

The replicator plate provides *in situ* adjustment ($\pm 7.5^\circ$) for both version and neck angle without the need for trials or back-table assembly.¹⁴⁻¹⁶ Two eccentricities (head and replicator plate) provide independent adjustability of both medial and posterior offset to empower the surgeon to anatomically orient the humeral head.¹⁴⁻¹⁶

Intra-operative Flexibility

The primary stem enables surgeons to convert from a total shoulder to a reverse without stem removal¹⁸. Multiple head heights for each diameter provides surgeon flexibility in patients with soft tissue challenges, and the alpha and beta glenoid curvatures enable any head size to be paired with any glenoid size while maintaining an optimal radial mismatch of approximately 5.5mm.¹¹⁻¹³

Augmented glenoid options offer bone preserving¹⁷ solutions for challenging glenoids. The new Cage Glenoid enhances fixation through an interference fit of the plasma coated central cage.



References

1. **Roche C, et al.** Scapular notching radiographic analysis: recommendations for glenoid plate positioning and glenosphere overhang in male and female patients. Transactions of the 58th Annual Meeting of the Orthopaedic Research Society. San Francisco, CA.
2. **Flurin, P, et al.** A correlation of five commonly used clinical metrics to measure outcomes in shoulder arthroplasty. Transactions of the 58th Annual Meeting of the Orthopaedic Research Society. San Francisco, CA.
3. JBJS, Sirveaux (2004); JBJS, Werner (2005); JSES, Boileau (2006); JBJS, Simovitch (2007); JSES, Karelse (2008); Clin Orthop Relat Res, Levigne (2010); Acta Orthop, Stechel (2010); JSES, Kempton (2011).
4. **Roche C, Flurin PH, Wright T, Crosby L, Mauldin M, Zuckerman J.** Geometric analysis of the grammont reverse shoulder prosthesis: an evaluation of the relationship between prosthetic design parameters and clinical failure modes. Proceedings of the 19th Annual Congress of the International Society for Technology in Arthroplasty; 2006 Oct 6-9; New York, NY.
5. **Roche C, Flurin PH, Wright T, Crosby L, Maulding M, Zuckerman J.** An evaluation of the relationships between reverse shoulder design parameters and range of motion, impingement, and stability. *J Shoulder Elbow Surg.* 2009 Sep-Oct;18(5):734-41.
6. **Roche C, Flurin PH, Wright T, Crosby L, Zuckerman J.** Effect of varying screw configuration and bone density on reverse shoulder glenoid fixation following cyclic loading. Poster presented at the 54th Annual Orthopaedic Research Society Meeting; 2008 Mar 2-5; San Francisco, CA.
7. Animal study on file at Exactech.
8. **Flurin P, Wright T, Zuckerman J, Angibaud L, Roche C.** Reconstruction of anatomic humeral head retroversion following four-part fractures of the proximal humerus: a comparison of two techniques. Poster presentation at the 51st Annual Meeting of the Orthopaedic Research Society. Washington, D.C. 2005.
9. **Flurin P, Wright T, Zuckerman J, Angibaud L, Roche C.** Three-dimensional analysis of the bicipital groove and the implications for the proximal humerus fracture prosthetic design. Proceedings of the Association of Shoulder and Elbow Surgeons. New York, NY: Closed Meeting; 2004.
10. **Angibaud L, Zuckerman J, Flurin P, Roche C, Wright T.** Reconstructing proximal humeral fractures using the bicipital groove as a landmark. *Clin Orthop.* 2007 May;458:168-74.
11. **Anglin C, et al.** Mechanical testing of shoulder prostheses and recommendations for glenoid design. *J Shoulder Elbow Surg.* 2000;9(4):323-31.
12. **Walch G, et al.** The influence of glenohumeral prosthetic mismatch on glenoid radiolucent lines. *J Bone Joint Surg.* 2002;84-A(12):2186-91.
13. **Karduna AR, et al.** Glenohumeral joint translations before and after TSA. *J Bone Joint Surg.* 1997; 79-A(8):1166-74.
14. **Roche, C. et al.** Biomechanical Analysis of 3 Commercially Available Reverse Shoulder Designs in a Normal and Medially Eroded Scapula. Trans. of the 59th Annual ORS Meeting. 2013.
15. **Roche, C. et al.** Impact of Scapular Notching on Reverse Shoulder Glenoid Fixation. Trans. of the 59th Annual ORS Meeting. 2013.
16. **Roche, C. et al.** A Comparison of Glenoid Fixation using Two Different Reverse Shoulder Designs with an Equivalent Center of Rotation in a Low and High Density Bone Substitute. Trans. of the 59th Annual ORS Meeting. 2013.
17. **Roche, C. et al.** Computer Assessment of Scapula Cortical and Cancellous Bone Removal when Correcting a Posterior Defect Using 3 Different Glenoid Prosthesis Designs. Trans. of the 59th Annual ORS Meeting. 2013.
18. **Crosby, L.A. et al.** Revision Total Shoulder Arthroplasty with and without Humeral Stem Removal: How Much of a Difference Does it Make in the Overall Results? Trans of the 23rd Annual BESS Scientific Meeting. 2012.

Exactech is proud to have offices and distributors around the globe.
For more information about Exactech products available in your country, please visit www.exac.com

The products discussed herein may be available under different trademarks in different countries. All copyrights, and pending and registered trademarks, are property of Exactech. This material is intended for the sole use and benefit of the Exactech sales force and physicians. It should not be redistributed, duplicated or disclosed without the express written consent of Exactech.

352-377-1140
1-800-EXACTECH
www.exac.com



©2013 Exactech
718-00-21 RevE 0113

A Great Day in the O.R.™