

medical**bees**<sup>♂</sup>

**Powertools** **bee-system** II  
Li-Ion - Technology



BEST QUALITY  
Made in  
Germany



# medicalbees

medicalbees Your address for surgical quality instruments "Made in Germany", manufactured at our site in Emmingen near Tuttlingen. medicalbees stands for highest quality, speed and efficiency. We will find the technically and economically optimal solution for you. Highest quality at fair prices. Contact us to get to know the complete medicalbees product range! For further information please visit: [medical-bees.de](http://medical-bees.de) or by email at [sales@medical-bees.de](mailto:sales@medical-bees.de)

## bee-system||

Li-Ion - Technology

**The idea:** Unique durability - all integrated components: motor, battery and electronics in removable unit.  
No need to sterilize delicate components. Only outer housing goes into the autoclave.  
Innovative design with intuitive and easy-to-use symbols.

**Design:** Newest Li-Ion technology for long lifetime with no-memory effect.  
The innovative battery-driven Power System

bee-system|| The new beesystem|| with a more ergonomic handpiece with slimmer handle and easier closing mechanism.





## 1 Powerpack for all 5 machines

**Technology:** Concept with newest battery technology and longer life time.  
 Li-Ion-Technology - Innovative solutions brought to the point  
 The innovative battery-driven Power-system concept with newest Li-Ion battery technology and longer lifetime.  
 With new ergonomic design, improved closing mechanism and easier cleaning/ maintenance.  
 All adapters and the Powerpack remain compatible with beesysteml and beesystemll.

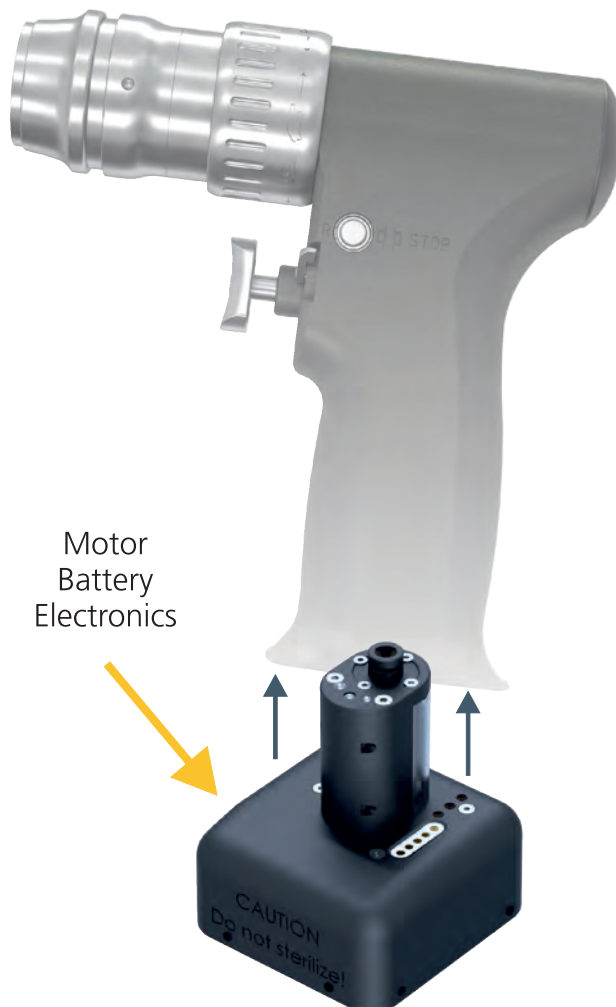

### Table of contents:

Page: 2-3:	<b>bee-systemll</b>
Page 4:	<b>Drill &amp; Ream</b> F-31-100-00
Page 5:	<b>Standard Drill</b> F-31-150-00
Page 6:	<b>Oscillating reamer</b> F-31-700-00
Page 7:	<b>Oscilating saws</b> F-31-300-00 F-31-301-00 F-31-310-00
Page 8:	<b>Sternum reciprocating saw</b> F-31-601-00
Page 9:	<b>Powerpack</b> F30-900-00
Page: 10:	<b>Charger</b> F-30-900-50
Page 11:	<b>additional accessoires</b>
Page 12:	<b>medicalbees</b>

## Drill&Ream

F-31-100-00

The new beesystemII universal Drill& Ream handpiece for all orthopaedic indications and large bone surgery. Drill&Ream machine with Right/ Left (CW and CCW) rotation lever for oscillating mode on/off and trigger for manual speed regulation with ring for switch drill and ream mode.

- With Right/ Left (forward/ backward rotation)

**R L**

- Lockposition

**db STOP**

- Oscillating mode on



off



- Continuously adjustable rotation speed



- Drill with 2 speed ranges  
Switch to change from Drill to Ream mode



### Technical data **F-31-100-00 Drill&Ream machine**

Handpiece dimensions (without attachment)	162 x 93 x 198 mm
Weight of handpiece with power pack	1850 g
Continuously adjustable rotation speed	0 - 1000 rpm (drill mode) 0 - 250 rpm (ream mode)
Cannulation	Cannulation of Ø 4.3mm
Protection class	B, EN 60601-1
Power supply	Internal battery

For all available accessories please see page 9-11 and Catalogue for additional options (F-30-000-07)



# Standard Drill

F-31-150-00:



The new beesystemII small handpiece for all drill attachments incl. Kirschner pin driver with continuously adjustable rotation speed.

- With Right/ Left (CW/ CCW) rotation



- Lockposition



- Continuously adjustable rotation speed

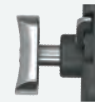

## Technical data **F-31-150-00 standard drilling machine**

Handpiece dimensions (without attachment)	137 x 93 x 197 mm
Weight of handpiece with power pack	1660 g
Continuously adjustable rotation speed	0 - 1000 rpm
Cannulation	Cannulation of Ø 4.3mm
Protection class	B, EN 60601-1
Power supply	Internal battery

For all available accessories please see page 9-11 and Catalogue for additional options (F-30-000-07)

# Oscillating reaming machine

F-31-700-00

The new oscillating reaming machine for use in anterior cruciate ligament reconstruction

- With Right/ Left (CW/CCW) rotation

**R L**

- Lockposition

**db STOP**

- Continuously adjustable rotation speed



## Technical Data **F-31-700-00 oscillating reaming machine**

Handpiece dimensions (without attachment)	140 x 111 x 206 mm
Mass of handpiece with power pack	1550 g
Continuously adjustable rotation speed	0 - 9000 rpm (Step I) 0 - 11000 rpm (Step II)
Protection class	B, EN 60601-1
Power supply	Internal battery

For all available accessories please see page 9-11 and Catalogue for additional options (F-30-000-07)



## Oscillating saws

- F-31-300-00
- F-31-301-00
- F-31-310-00



Sagittal oscillating saw in bone surgery:

- With rotatable saw blade clamping in 45° steps (8 positions)
- Manual speed adjustment and oscillating mode
- Shift lever for operating in two different speeds
- Available in 2 variants with 2° and 4° lateral saw blade movement.
- With AO-Synthes and Stryker connection of the saw blade

Oscillating saws are available in three version.

**F-31-300-00:** oscillating saw, 4° (lateral movement) - for Synthes / AO saw-blades

**F-31-301-00:** oscillating saw, 2° (lateral movement) - The lateral movement of the saw blade is set from the center line in this model to 2° (instead of 4°)

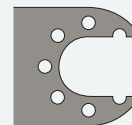

**F-31-310-00:** oscillating saw for Stryker sawblades

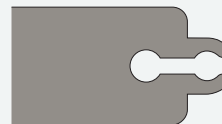

### Technical Data **F-31-300-00 / F-31-301-00 oscillating saws**

Handpiece dimensions (without attachment)	166 x 111 x 211 mm
Mass of handpiece with power pack	1760 g
Continuously adjustable rotation speed	0 - 9000 cpm (Step I) 0 - 11000 cpm (Step II)
Protection class	B, EN 60601-1
Power supply	Internal battery

For all available accessories please see page 9-11 and Catalogue for additional options (F-30-000-07)

## Sternum saw

F-31-601-00

Sternum saw with protection sleeve and keyless chuck with continuously adjustable rotation speed and switch lever from Step I to II. Basic model can be used as reciprocating saw.

Rotate the attachment/chuck to the desired position. Locking always at 90°

- Precise cutting guide with good visibility conditions
- Easy clamping of sawblade (no tools required),
- Use of saw blades with Stryker adaption
- Attachment of protection sleeve in 4' different positions possible ( Locking at 90°)
- basic model to be used as reciprocating



### F-31-601-00:

Sternum saw, includes F-30-400-05 Sternum protection sleeve, 70mm

### F-30-400-10:

XL-Sternum protection sleeve, 80mm

For all available accessories please see page 9-11 and Catalogue for additional options (F-30-000-07)



### Technical Data F-31-601-00 Sternum saw

Handpiece dimensions (without attachment)	185 x 111 x 206 mm
Mass of handpiece with power pack	1750 g
Continuously adjustable rotation speed	0 - 7500 cpm (Step I) 0 - 10000 cpm (Step II)
Protection class	B, EN 60601-1
Power supply	Internal battery





# Powerpack

(compatible to both beesystemI and beesystemII machines)  
F-30-900-00



**Do not sterilize**

Powerpack, universal drive unit for use with all beesystem handpieces, newest Li-Ion technology.

The heart of the system:

1 Powerpack for all handpieces

- Includes control unit, battery, electronics and motor - all united in one Powerpack
- Automatic recognition of the performance parameters according to the used handpiece
- Unique durability, no need to sterilize delicate components
- Latest battery technology – long lifetime no memory effect
- Display for battery charging status: green, orange, red (discharged)
- White LEDs for additional illumination of the OR field

## Technical Data F-30-900-00 Powerpack (battery)

Dimensions	89 x 87 x 102 mm
Weight	760 g
Type	Li-ion
Max. voltage	16.8 V
Operating voltage (rated voltage)	14.4 V
Capacity	2.1 Ah
Typical charging time period	< 90 min

Accessories:

F-30-900-20: Sterile funnel (compatible to both beesystemI and beesystemII) handpieces

## Charging units

for use with Powerpack F-30-900-00

All charging units indicate the charging status of the Powerpacks:  
In addition to the charging status on the Powerpack the charger indicates per Powerpack slot the charging capacity:

Powercable (to be ordered separately)

F-30-900-53	Powercable EU
F-30-900-54	Powercable UK
F-30-900-55	Powercable USA
F-30-900-56	Powercable Australia
F-30-900-57:	POAG Cable



### Technical Data **F-30-900-50 charger (single)**

Dimensions	157 x 140 x 79 mm
Mass	1740 g
Type	Li-ion battery charger
Input	100 - 240 V AC 50 - 60 Hz 0,9 A
Output	16,8 V DC 2,0 A



### Technical Data **F-30-900-51 charger (double)**

Dimensions	240 x 190 x 130 mm
Mass	4939 g
Type	Li-ion battery charger
Input	100 - 240 V AC 50 - 60 Hz 0,9 A
Output	16,8 V DC 2,0 A



### Technical Data **F-30-900-52 charger (quadruple)**

Dimensions	636 x 140 x 79 mm
Mass	6960 g
Type	Li-ion battery charger
Input	100 - 240 V AC 50 - 60 Hz 0,9 A
Output	16,8 V DC 2,0 A



## Accessoires

For all available accessories please see Catalogue for additional options (F-30-000-07)



medicalbees

**Powertools  
Accessoires**

bee-system||  
Li-Ion - Technology

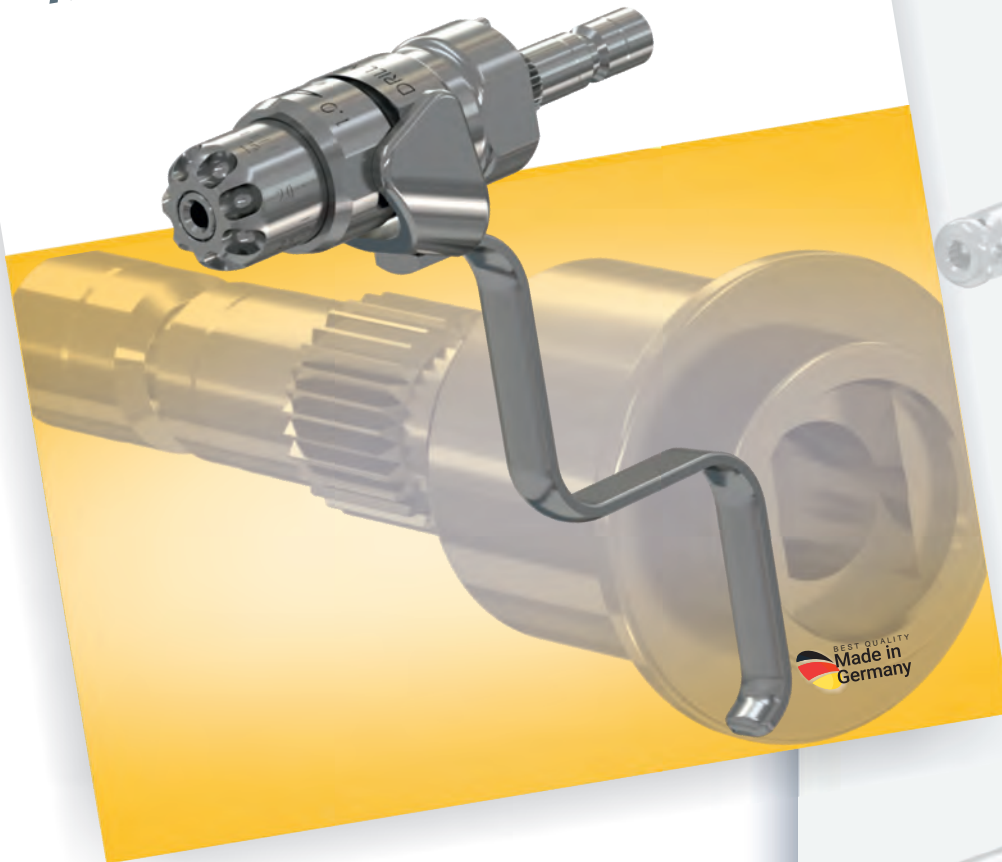

BEST QUALITY  
Made in  
Germany



➔ This could also interest you:

MF-cranial stabilization system



beesystem flyer



Changes in technical specifications and dimensions are at our discretion. Subjekt to modification. Without our explicit written approval this print media may not be copied or reprinted as a whole or in extracts.



**NEW product Database!**

Get to know our products with our new Product Database

