

rejoin 



rejoin 

Hangzhou Rejoin Mastin Medical Device Co., Ltd

Headquarter Office: 22 Xinyan Rd, Linping Economic Development Zone, Hangzhou, Zhejiang, 311100, P.R. of China
Beijing Branch: Room 1605, Jinghui building, No. 118 Jianguo Road, Chaoyang District, Beijing, P.R. of China
Shanghai Branch: 309A, L1-B, Hongqiao World Center, 1588 Zhuguang Rd, Qingpu District, Shanghai, P.R. of China

contact@rejoin.com @rejoinmedical www.rejoin.com
www.rejoin-medical.com

The content in this document is provided for reference only

FusionLoc[®]
GripLoc[®]
RealLoc[®]
PEEK Anchor



FusionLoc® Anchor, PEEK

Rotator Cuff Repair

- Open & vented design facilitates bone ingrowth, accelerates the healing
- Implanted with less material decrease the risk of foreign body reaction
- Fully-threaded anchor design provides significantly more threaded engagement, delivering greater pullout strength in poor-quality, osteoporotic bone
- WilSuture® Ultra tape with soft, smooth feel provides broader footprint over tissue to decrease suture-tissue tear
- Size: 4.5mm & 5.5mm

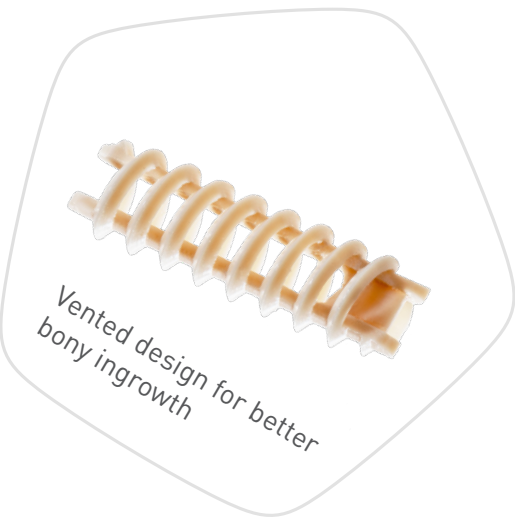
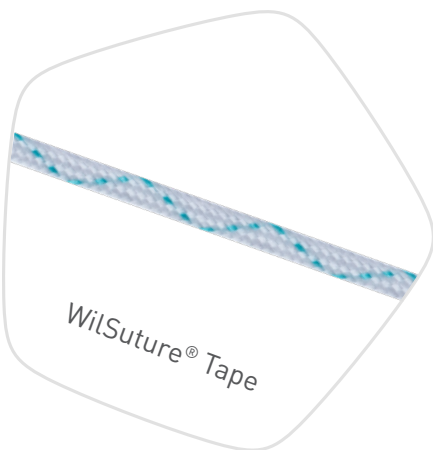

GripLoc® Knotless Anchor, PEEK



GripLoc® Knotless Anchor, PEEK



GripLoc® Knotless Anchor, PEEK



Rotator Cuff Repair



- Knotless design: better option for Double Row technique
- Maximum fixation strength, better pull-out strength and low displacement
- Cannulated and vented design facilitates bony ingrowth and decreases peek material implantation
- Flexiable application with WilSuture® Ultra Tape and WilSuture® Ultra Suture
- Ergonomic handle designed for surgeon comfort and ease of use
- Size: 3.5mm & 4.75mm & 5.5mm

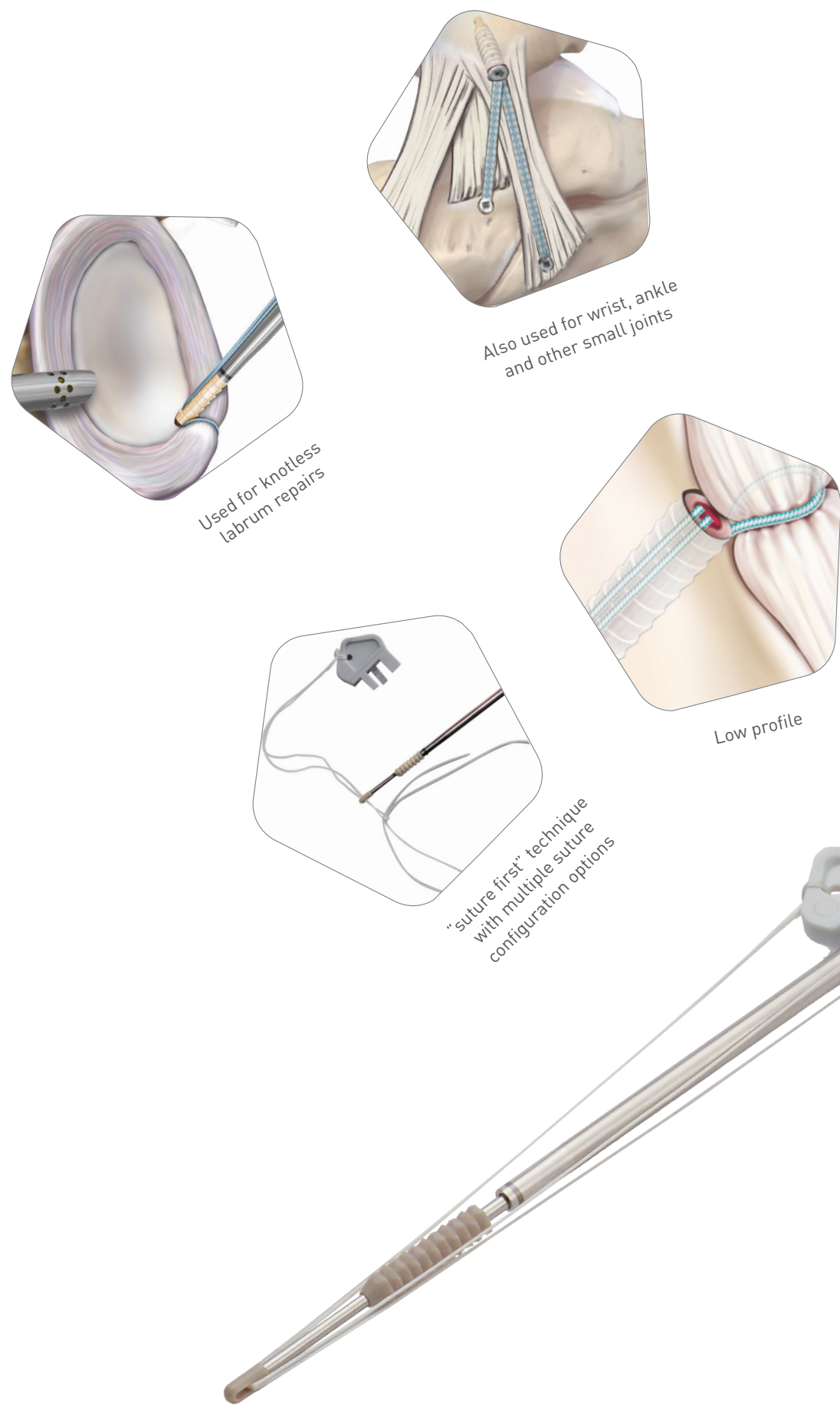

Also used for wrist, ankle
and other small joints

Used for knotless
labrum repairs

Low profile

"suture first" technique
with multiple suture
configuration options

Remove the safety tab, tap the anchor in until
the laser line is flush and rotate the inserter
counterclockwise six full revolutions to unlock
the anchor

RealLoc® Anchor, PEEK

Labrum Repair

- Knotless technique saves surgical time and quickly repair the labrum
- No risk of knot impingement
- Suture tension is visualized and adjusted prior to anchor insertion
- Size: 2.5mm & 2.9mm & 4.5mm

Ordering Information

Code	Description
800614100	RealLoc PEEK Suture Anchor, 2.5mm×8mm
800614200	RealLoc PEEK Suture Anchor, 2.9mm×15.5mm
800614400	RealLoc PEEK Suture Anchor, 4.5mm×24mm
RJ8108003	Punch for 2.5mm RealLoc
RJ8108004	Punch for 4.5mm RealLoc
RJ8106001	1.8mm drill bit for 2.5mm RealLoc
RJ8106002	2.0mm drill bit for 2.5mm RealLoc
RJ8106003	Drill guide for 2.5mm RealLoc
RJ8106001	Drill for 2.9mm RealLoc
RJ8106006	Drill for 2.9mm RealLoc (hard bone)
RJ8106009	Spade Tip Drill for 2.9 mm RealLoc
RJ8106008	Drill Guide, Trocar and Blunt Tip Obturator for 2.9 mm RealLoc
RJ8106010	Drill guide, Trocar Tip Obturator for 2.9 mm RealLoc
RJ8106007	Offset Guide for 2.9 mm RealLoc